

PROPRIETARY INFORMATION
 INFORMATION CONTAINED HEREIN IS THE PROPERTY OF HURCO MANUFACTURING COMPANY, INC. NO REPRODUCTION OR DISCLOSURE OF THIS INFORMATION SHALL BE MADE BY THE RECIPIENT TO ANY OTHER PERSON OR ORGANIZATION WITHOUT THE PRIOR WRITTEN CONSENT OF HURCO MANUFACTURING COMPANY, INC.

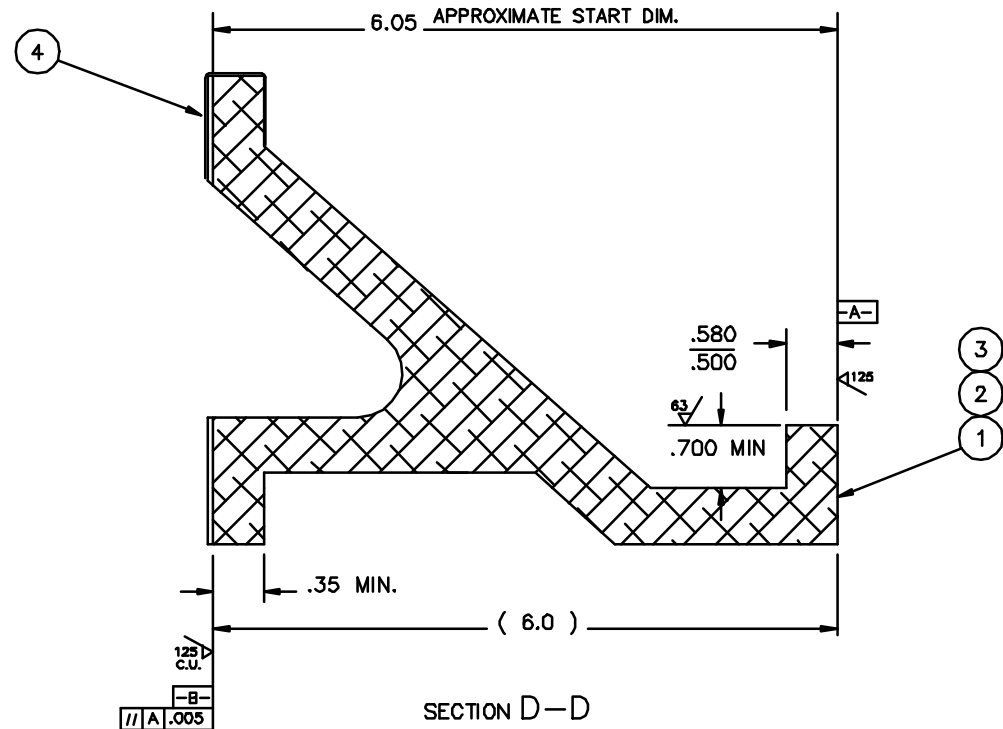
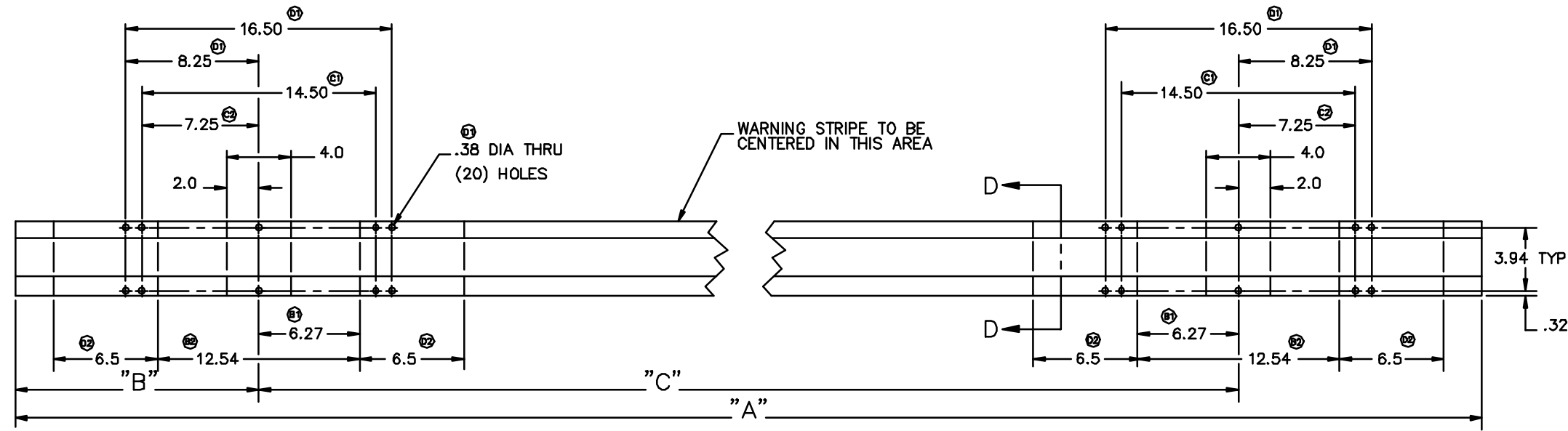

PART LIST ITEMS			
ITEM	LENGTH "A"	DIM B	DIM C
-026	90" (7'-6")	15.12	59.75
-027	96" (8'-0")	18.12	59.75
-028	102" (8'-6")	16.12	69.75
-029	108" (9'-0")	15.12	77.75
-030	114" (9'-6")	18.12	77.75
-031	120" (10'-0")	16.12	87.75
-032	126" (10'-6")	19.12	87.75
-033	132" (11'-0")	15.12	101.75
-034	138" (11'-6")	18.12	101.75
-035	144" (12'-0")	21.12	101.75
-036	150" (12'-6")	24.12	101.75
-037	156" (13'-0")	19.12	117.75
-038	162" (13'-6")	22.12	117.75
-039	168" (14'-0")	25.12	117.75

NOTES:

- 1.) WHEN MACHINING SURFACE -A- SHIM UNDER CLAMPS.
- 2.) SURFACE "A" STRAIGHT WITHIN .010 TOTAL.
- 3.) SURFACE "A" STRAIGHT WITHIN .001 PER FOOT.
- 4.) SURFACE "B" TO BE REGARDED SEPARATELY.
- 5.) WHEN GAUGE BAR IS CLAMPED AT SURFACE -B-, SURFACE -A- TO BE PERPENDICULAR TO TABLE WITHIN .005.

NOT SHOWN

2	2	2	2	2	2	2	2	2	2	2	2	2	2	2	614-0002-046	END CAP & FILLER, 33 X 17 5/8 350#	9
2	2	2	2	2	2	2	2	2	2	2	2	2	2	2	614-0002-045	WRAP COLLAR, 26 3/16 X 6 350# D.W.	8
2	2	2	2	2	2	2	2	2	2	2	2	2	2	2	614-0002-051	CARDBOARD SPACER, 6" GAUGE BAR	7
1	1	1	1	1	1	1	1	1	1	1	1	1	1	1	614-0002-042	CART BRD, 54 1/8 X 144 350# D.W.	6
1	1	1	1	1	1	1	1	1	1	1	1	1	1	1	614-0002-044	CARDBOARD, 54 1/8 X 90" DW 350	5
7.7'	7.7'	7.7'	6.3'	6.3'	6.3'	6.3'	5.2'	5.2'	4.3'	4.3'	3.7'	2.8'	2.8'	703-0003-009	TAPE, WARNING STRIPE	4	
-	-	-	-	-	-	-	-	-	1	-	-	-	-	-	801-0654-805	EXTRUSION, 114" ALUMINUM GAUGE BAR	3
-	-	-	-	-	-	-	-	-	-	-	-	-	-	-	801-0654-801	EXTRUSION, 90" ALUMINUM GAUGE BAR	2
"A"	"A"	"A"	"A"	"A"	"A"	"A"	"A"	"A"	"A"	"A"	"A"	"A"	"A"	-	801-0654-000	EXTRUSION, ALUMINUM GAUGE BAR	1
QTY.	QTY.	QTY.	QTY.	QTY.	QTY.	QTY.	QTY.	QTY.	QTY.	QTY.	QTY.	QTY.	QTY.	QTY.	PART NUMBER	ITEM DESCRIPTION	ITEM

REV	DATE	BY	DESCRIPTION	DATE	BY	DATE	BY
D	13800		1) ADDED 8 HOLES; (2) WAS 6 Q; (3) REMOVED PART NO -040 THRU -046				
C	13214		1) WAS 14.54; (2) WAS 7.27				
B	12516		1) WAS 6.1; (2) WAS 12.20				
A	12272		REL				

DESCRIPTORS	EXCEPT AS NOTED: ALL DIMENSIONS IN INCHES TOLERANCE	HURCO MANUFACTURING COMPANY, INC. INDIANAPOLIS, IN U.S.A.
DECIMAL	.0 .0300	SURFACE TREATMENT ~ HEAT TREATMENT ~ FIRST USED ON S8
.00	± 0180	
.000	± 0050	
.0000	± 0005	
ANGULAR	° 0730'	DESCRIPTION
BREAK ALL SHARP EDGES		GAUGE BAR, STD "Y" SECTION - S8
THIRD ANGLE PROJECTION	SCALE 1=4	DRAWN
UNIT OF MEAS. EA.	SIZE	DATE
		8-6-92
		CHECKED
		KLP
		DATE
		8-7-92
		APPROVED
		WEH
		DATE
		8-1-92
		REV.
		SH1
		1
		OF
		1